



SERIES 2000 EPROM REPLACEMENT KIT P/N: 250068065

REPLACEMENT GUIDE

The E-Prom Replacement Kit includes all the necessary equipment needed to replace the EPROM for the following Bill Acceptors:

- Series 2000
 - ◆ VN2500
 - ◆ AE2400
- Series 2000 with MEI FlashPort
 - ◆ VN2500¹
 - ◆ AE2400¹
 - ◆ AE2600²

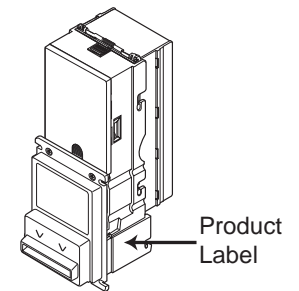

¹**NOTE:** MEI started manufacturing the VN2500/AE2400 with MEI FlashPort on the 40th week of 1999. To verify if a unit was manufactured with MEI FlashPort capability check the product label for the words “with MEI FlashPort” or check the serial number of the unit to determine when it was manufactured. The first 2 digits of the serial number represent the week the unit was manufactured (1 - 52). The third digit represents the year the unit was manufactured (5 - 0).

S/N 499XXXXXXXXX - unit manufactured the 49th week of 1999

²**NOTE:** All AE2600 have MEI FlashPort capability.

The E-Prom Replacement Kit consist of the following:

- Wrist Grounding Strap
- Chip Extractor
- Replacement Guide

REMOVING THE OLD CHIP

Questions should be directed to MEI Technical Support at 1-800-345-8172 or our web site: www.meiglobal.com.

- 1) Remove the Bezel screws. Then carefully remove the Bezel. If necessary remove the Bezel Bracket screws. Then remove the Bezel Bracket and Control Board Cover.

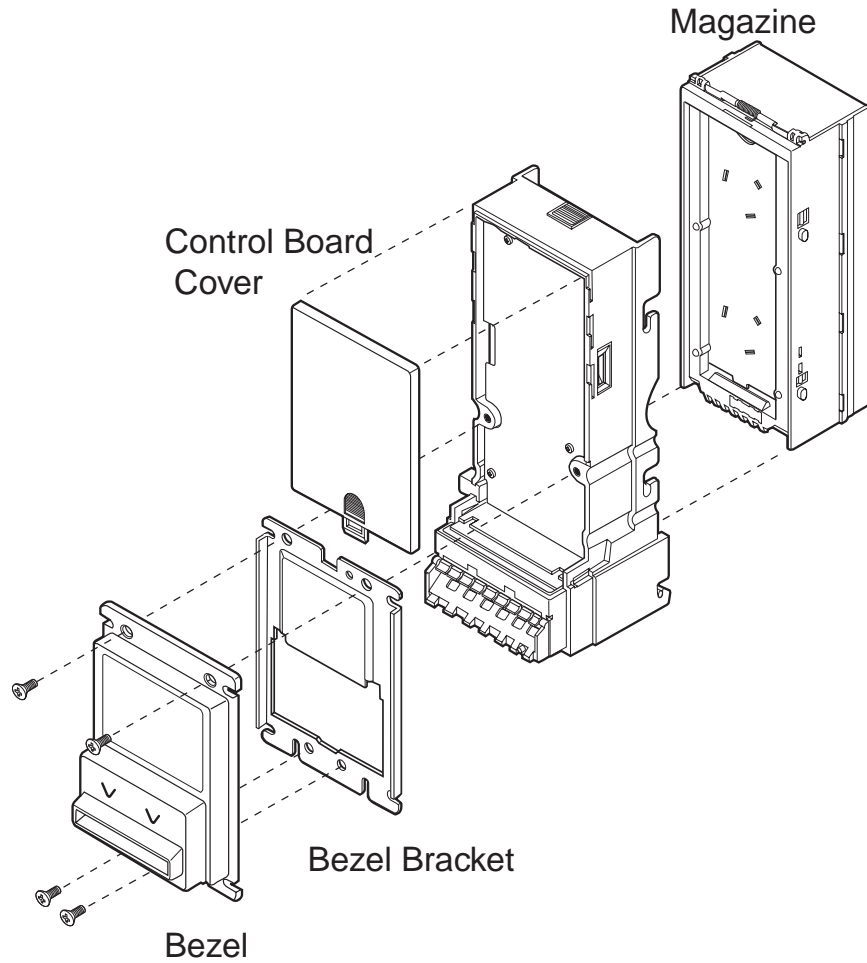

INSTALLING THE NEW CHIP

- 1) Identify the chamfered corner of the new chip.

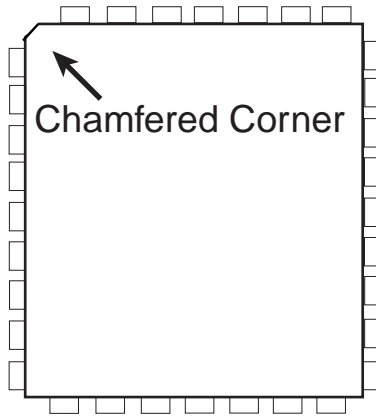

- 2) Align the chamfered corner of the new chip with the chamfered corner of the chip socket.
- 3) Press the chip into the chip carrier.

The chip carrier should receive the chip without much effort. **DO NOT FORCE THE CHIP INTO THE CHIP SOCKET!** If the chip does not install easily, recheck the alignment of the chip to the socket.

NOTE: Make sure the chip is firmly in place - press on all four corners of the chip. **DO NOT USE A SCREWDRIVER OR ANY OTHER SHARP METAL INSTRUMENT TO PERFORM THIS TASK.**

- 4) Ensure the harnesses connected to the Control Board are seated properly then reassemble the unit.

- 2) Remove the LED Harness from the LED Harness holder. Remove the Magazine and then lay unit on its back and remove the Control Board screws. Gently remove the Control Board by lifting on the LED Harness Stopper, then lift on side of the Control Board as shown below.

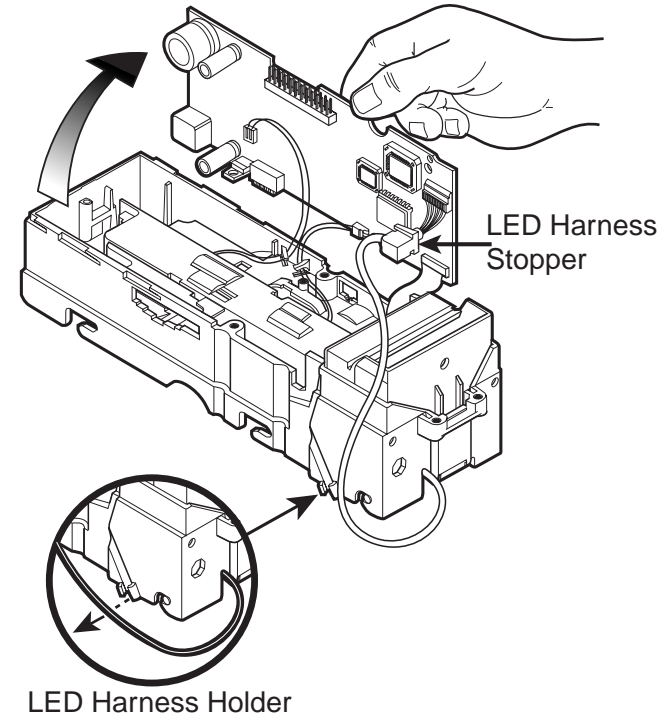
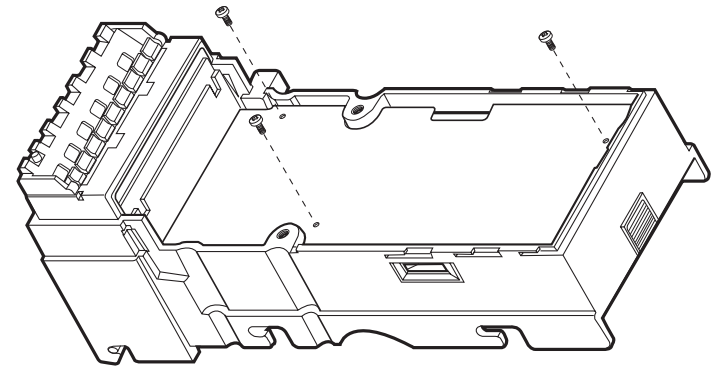

3) Locate the EPROM socket on the Control Board.

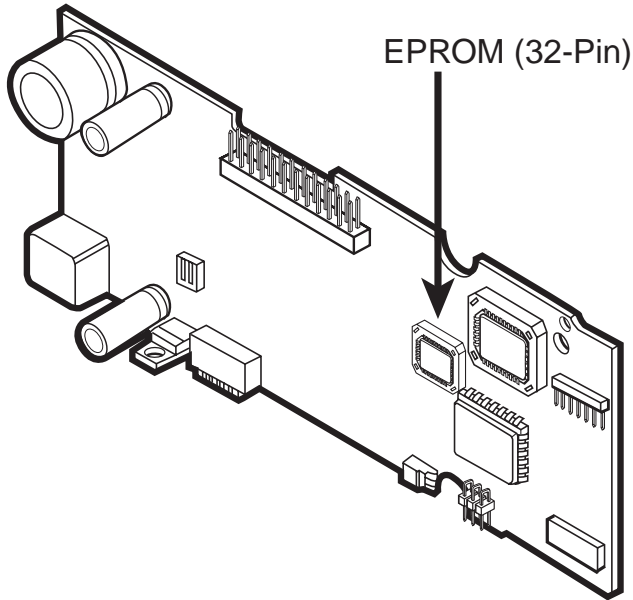

Series 2000 with MEI FlashPort

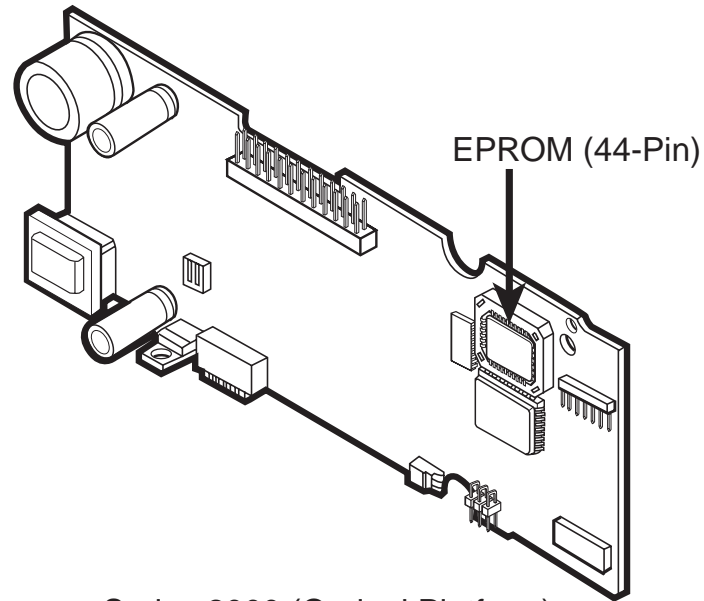

Series 2000 (Original Platform)

4) Remove the EPROM from its socket. Use an AMP extraction tool for plastic leaded chip carriers or equivalent tool. Locate the extraction slots.

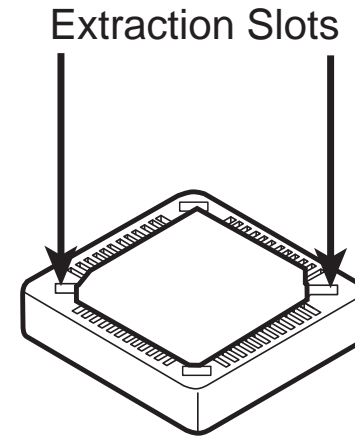

5) Lower the extraction tool into the extraction slot until it bottoms out. Then pull the tool back away from the socket using slight pressure until the corner of the chip lifts away. Repeat on the opposite extraction slot and lift the chip out of the socket.

